

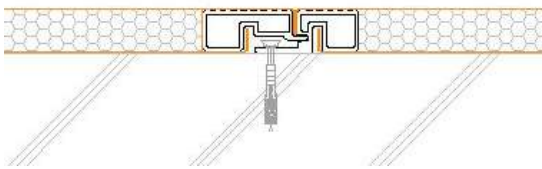

## 17.5mm Aluminium Honeycomb Lining Panel Secret Fix Lining Panel

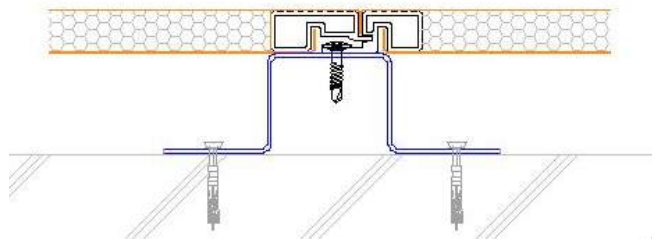

**Option 1 - Direct fix to wall**



**Option 2 - Batten fix to wall**

### Summary Specification

Thickness	17.5mm
Standard Dimensions	2500/3000mm x 1200mm
Core	16.3mm Thick ½" Aluminium Honeycomb 3003 Grade
Facing Skin	0.5mm Galvanised Steel Substrate with Specified Finish/ Stainless-steel/Aluminium Powder Coat
Finish For Galvanised Steel Substrate	UPVC Laminate / Polyester Painted / Primer / P.E.T
Adhesive	2 pack solvent free adhesive @ 300g/m <sup>2</sup> per face
Weight	10.66 kg/m <sup>2</sup>
Max. Length	3000 mm
Joint	Interlocking edge extrusion to long sides secret fix. 4 sided extrusion option to allow stacking of panels for heights above 3000mm
Fire Resistance	Class 'O'
FM Approval	4882